

LMDA-VPA series

Twin wheel light duty castors with bolt hole, wheels with solid rubber tyres

80–100 kg

Bracket: LMDA series

- pressed steel, zinc-plated, blue-passivated, Cr6-free
- double ball bearing in the swivel head
- pressed swivel head

Wheel: VPA series

- tyre: high-quality solid rubber, hardness 80 Shore A, colour grey, non-marking, non-staining
- rim: high-quality nylon 6 or polypropylene in the electrically conductive version "-EL", impact resistant, colour black

Additional details:

- bracket series: page 86
- brakes: page 112–113
- wheel series: page 127
- bearing types: page 84–85



1

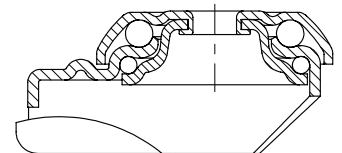

| Swivel castors | Swivel castors with "stop-fix" brake | Wheel Ø [mm] | Wheel width [mm] | Load capacity [kg] | Bearing type | Total height [mm] | Plate Ø [mm] | Bolt hole Ø [mm] | Offset swivel castor [mm] |
|----------------|--------------------------------------|-----------------|---------------------|-----------------------|--------------|----------------------|-----------------|---------------------|------------------------------|
| LMDA-VPA 50G | LMDA-VPA 50G-FI | 50 | 2 x 18 | 80 | plain bore | 71 | 41 | 10.2 | 31 |
| LMDA-VPA 50K | LMDA-VPA 50K-FI | 50 | 2 x 18 | 80 | ball bearing | 71 | 41 | 10.2 | 31 |
| LMDA-VPA 75G | LMDA-VPA 75G-FI | 75 | 2 x 25 | 100 | plain bore | 98 | 55 | 10.2 | 34 |
| LMDA-VPA 75K | LMDA-VPA 75K-FI | 75 | 2 x 25 | 100 | ball bearing | 98 | 55 | 10.2 | 34 |

Versions / options



| | |
|---|----------------------------|
| electrically conductive version, black tyre | |
| Technical description page | 50 |
| Product code suffix | -EL |
| Available for | all ball bearing versions* |

* Wheel load capacity of electrically conductive version reduced by 25%