

VPP series, wheel Ø 80–180 mm

Wheels with standard solid rubber tyres, with synthetic rim



50–170 kg

Tread and tyre hardness

80 Shore A

Smooth operation / floor preservation

very good

Rolling resistance

satisfactory

Wear resistance

sufficient

Tyre:

- standard solid rubber, hardness 80 Shore A
- very good operational comfort
- very good floor preservation, low-noise operation
- colour black

Rim:

- high-quality polypropylene, impact resistant
- colour black

Other features:

- high chemical resistance to many aggressive substances, except oils
- operating temperature: -20 °C to +60 °C, reduced load capacity over +30 °C

Additional details:

- wheel series: page 61
- tread: page 52
- bearing types: page 84–85
- chemical resistance: page 51

Wheels	Wheel Ø (D) [mm]	Tyre width (T2) [mm]	Load capacity [kg]	Bearing type	Axle bore Ø (d) [mm]	Hub length (T1) [mm]
VPP 80/12G	80	25	50	plain bore	12	35
VPP 80/12R	80	25	50	roller bearing	12	35
VPP 100/12G	100	30	70	plain bore	12	45
VPP 100/15G	100	30	70	plain bore	15	45
VPP 100/12R	100	30	70	roller bearing	12	45
VPP 100/15R	100	30	70	roller bearing	15	45
VPP 125/12G	125	37.5	100	plain bore	12	45
VPP 125/15G	125	37.5	100	plain bore	15	45
VPP 125/12R	125	37.5	100	roller bearing	12	45
VPP 125/15R	125	37.5	100	roller bearing	15	45
VPP 140/15G	140	37.5	115	plain bore	15	45
VPP 140/15R	140	37.5	115	roller bearing	15	45
VPP 150/20G	150	40	135	plain bore	20	60
VPP 150/20R	150	40	135	roller bearing	20	60
VPP 160/20-45G	160	40	135	plain bore	20	45
VPP 160/20G	160	40	135	plain bore	20	60
VPP 160/20-45R	160	40	135	roller bearing	20	45
VPP 160/20R	160	40	135	roller bearing	20	60
VPP 180/20G	180	50	170	plain bore	20	60
VPP 180/20R	180	50	170	roller bearing	20	60

For other wheel Ø, see next page

Versions / options



	with non-marking grey tyre	with stainless steel roller bearing in the wheel hub	STARLOCK® cap made from stainless steel
Technical description page	52	84	117
Product code suffix	-SG	-XR	ST-KA 12, 15, 20
Available for	all	upon request	all axle bore Ø

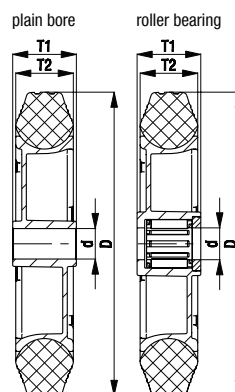

VPP series, wheel Ø 200–400 mm

Wheels with standard solid rubber tyres,
with synthetic rim



200–350 kg

Tread and tyre hardness

80 Shore A

Smooth operation / floor preservation

very good

Rolling resistance

satisfactory

Wear resistance

sufficient

3

Tyre:

- standard solid rubber, hardness 80 Shore A
- very good operational comfort
- very good floor preservation, low-noise operation
- colour black

Rim:

- high-quality polypropylene, impact resistant
- colour black

Other features:

- high chemical resistance to many aggressive substances, except oils
- operating temperature: -20 °C to +60 °C, reduced load capacity over +30 °C

Additional details:

- wheel series: page 61
- tread: page 52
- bearing types: page 84–85
- chemical resistance: page 51

Wheels	Wheel Ø	Tyre width	Load capacity	Bearing type	Axle bore Ø	Hub length
	(D) [mm]	(T2) [mm]	[kg]		(d) [mm]	(T1) [mm]
VPP 200/20G	200	50	205	plain bore	20	60
VPP 200/25G	200	50	205	plain bore	25	60
VPP 200/20R	200	50	205	roller bearing	20	60
VPP 200/20K	200	50	205	ball bearing	20	60
VPP 205/20G	200	65	200	plain bore	20	60
VPP 250/20G	250	60	295	plain bore	20	65
VPP 250/20-74G	250	60	295	plain bore	20	74
VPP 250/25G	250	60	295	plain bore	25	65
VPP 250/25-74G	250	60	295	plain bore	25	74
VPP 250/25R	250	60	295	roller bearing	25	65
VPP 250/20K	250	60	295	ball bearing	20	65
VPP 250/25K	250	60	295	ball bearing	25	65
VPP 254/25G	250	75	300	plain bore	25	65
VPP 256/20G	250	85	250	plain bore	20	75
VPP 256/20R	250	85	250	roller bearing	20	75
VPP 300/25G	300	60	250	plain bore	25	60
VPP 350/25R	350	75	300	roller bearing	25	75
VPP 400/25G	400	100	350	plain bore	25	75
VPP 400/25R	400	100	350	roller bearing	25	75

Versions / options



	with non-marking grey tyre	with stainless steel roller bearing in the wheel hub	STARLOCK® cap made from stainless steel
Technical description page	52	84	117
Product code suffix	-SG	-XR	ST-KA 20, 25
Available for	wheel Ø 200x50+250x60 mm	upon request	all axle bore Ø

