

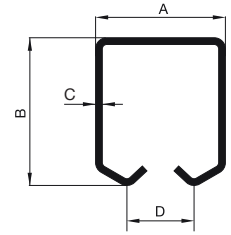

### Perfil superior acero

*Profil supérieur acier*

*Perfil superior aço*

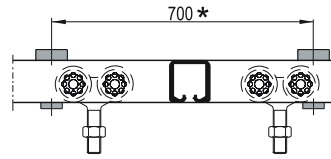

Código code/código	Tamaño	Material	A (mm)	B (mm)	C (mm)	D (mm)	
85-214	P	Acero	34	30	1,5	21,5	3 mts.
85-412	M	Acero	43	53	2,5	22,0	3 mts.
85-612	G	Acero	57	68	3,0	30,0	3 mts.

### Carro 2 rodamientos. Zincado

*Chariot 2 roulements. Zingué*



*Carro 2 rolamentos. Zincado*

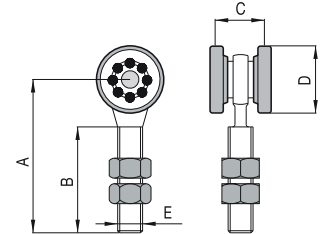

Rodamientos  
en acero

Rodamientos  
en nylon



Código code/código	Tamaño	Rodamientos roulements/rolamentos	A (mm)	B (mm)	C (mm)	D (mm)	E (mm)	 (Kg)	
85-216	P	Acero	51	35	21,5	ø24	M8	30	2
85-219	P	Nylon	51	35	21,5	ø24	M8	30	2
85-413	M	Acero	87	56	22,5	ø44	M12	250	2
85-613	G	Acero	122	85	30,0	ø54	M20	350	2

### Carro 4 rodamientos. Zincado

*Chariot 4 roulements. Zingué*



*Carro 4 rolamentos. Zincado*



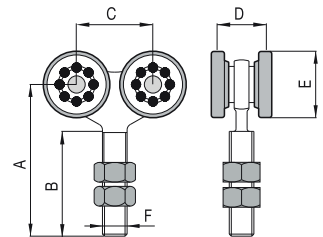

Rodamientos  
en acero

Rodamientos  
en nylon

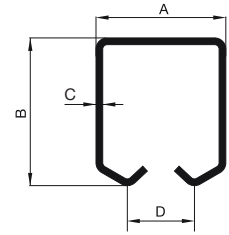

Código code/código	Tamaño	Rodamientos roulements/rolamentos	A (mm)	B (mm)	C (mm)	D (mm)	E (mm)	F (mm)	 (Kg)	
85-222	P	Acero	47	30	30	21,5	ø24	M8	50	2
85-225	P	Nylon	47	30	30	21,5	ø24	M8	50	2
85-416	M	Acero	105	70	50	22,0	ø44	M12	280	2
85-616	G	Acero	125	80	60	30,0	ø54	M20	400	2

**Perfil superior acero***Profil supérieur acier**Perfil superior aço*

Código code/código	Material	A (mm)	B (mm)	C (mm)	D (mm)	 (Kg)	
85-800	Acero	40	40	1,5	27	1,530/m	3 mts.
85-801	Acero	60	55	2,5	38	3,650/m	3 mts.

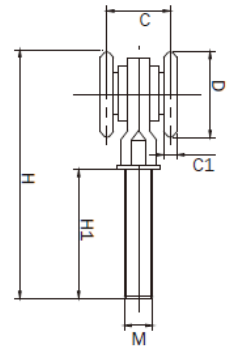
**Carro pivotante 2 roldanas***Charriot 2 roulements pivotante.**Carro 2 rolamentos pivotante.*

Código code/código	D (ø) (mm)	C (mm)	C1 (mm)	M (mm)	H (mm)	H1 (mm)	 (Kg)	
85-802	33,5	27	4	10	130	78	0,212	1

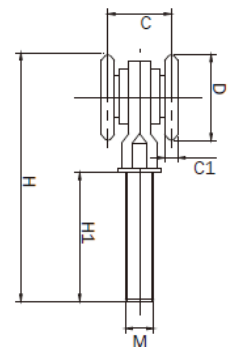
**Carr pivotante 4 roldanas***Charriot 4 roulements pivotante.**Carro 4 rolamentos pivotante.*

Código code/código	D (ø) (mm)	C (mm)	C1 (mm)	M (mm)	H (mm)	H1 (mm)	 (Kg)	
85-804	33,5	27	4	10	130	78	0,350	1