

BS-SPK series

Welded steel heavy-duty castors, with cast iron flanged wheel

800–3,500 kg

Bracket: BS series

- particularly robust welded steel construction
- zinc-plated, yellow-passivated, Cr6-free

Wheel: SPK series

- rugged grey cast iron, hardness 180–220 HB, with grease nipple from wheel Ø 125 mm, lacquered, colour silver
- the load capacities provided in the table refer to the allocation of flanged wheels to rail profiles in accordance with DIN 536 specified below (crane rail standard):
SPK 100K–SPK 200K, SPK 250K: A45
SPK 201K, SPK 251K: A55

Additional details:

- wheel series: page 528
- bearing types: page 84–85

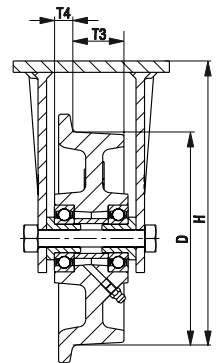

Fixed castors	Wheel Ø without flange (D) [mm]	Wheel Ø incl. flange [mm]	Wheel width [mm]	Running width (T3) [mm]	Flange location (T4) [mm]	Load capacity [kg]	Bearing type	Total height (H) [mm]	Plate size [mm]	Bolt hole spacing [mm]	Bolt hole Ø [mm]
BS-SPK 100K	100	125	46	36	13	800	ball bearing	157	140 x 110	105 x 75–80	11
BS-SPK 125K	125	145	46	36	13	900	ball bearing	170	140 x 110	105 x 75–80	11
BS-SPK 150K	150	175	46	36	13	1,000	ball bearing	200	140 x 110	105 x 75–80	11
BS-SPK 200K	200	230	53	38	10	1,500	ball bearing	245	140 x 110	105 x 75–80	11
BS-SPK 201K	200	230	80	60	20	3,000	ball bearing	245	175 x 140	140 x 105	14
BS-SPK 250K	250	300	65	50	17.5	2,500	ball bearing	305	175 x 140	140 x 105	14
BS-SPK 251K	250	300	80	60	25	3,500	ball bearing	305	200 x 160	160 x 120	14



with heat-resistant ball bearing up to +300 °C

Versions / options

Technical description page

84

Product code suffix

-IK

Available for

upon request*

* Load capacity see page 528