

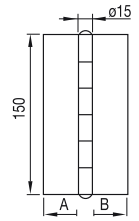

## Bisagra 2 alas

*Charnière 2 ailes.*

*Dobradiça 2 abas.*





Código code/código	Acabado	A (mm)	B (mm)	Espesor épaisseur/espessura (mm)	
84-101/10	Acero/acier/aço	42,5	42,5	3	12
84-101/12	Zincado/zingée/zincado	42,5	42,5	3	12
84-101/18	Acero/acier/aço	52,5	52,5	3	12
84-101/20	Zincado/zingée/zincado	52,5	52,5	3	12
84-101/26	Acero/acier/aço	62,5	62,5	3	10
84-101/28	Zincado/zingée/zincado	62,5	62,5	3	10
84-101/34	Acero/acier/aço	67,5	67,5	3	10
84-101/36	Zincado/zingée/zincado	67,5	67,5	3	10

## Bisagra reforzada 2 alas

*Charnière renforcée 2 ailes.*

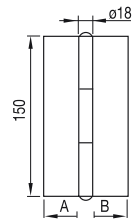
*Dobradiça reforçada 2 abas.*





Código code/código	Acabado	A (mm)	B (mm)	Espesor épaisseur/espessura (mm)	
84-102/10	Acero/acier/aço	41	41	3,5	12
84-102/12	Zincado/zingée/zincado	41	41	3,5	12
84-102/18	Acero/acier/aço	51	51	3,5	12
84-102/20	Zincado/zingée/zincado	51	51	3,5	12
84-102/26	Acero/acier/aço	61	61	3,5	10
84-102/28	Zincado/zingée/zincado	61	61	3,5	10
84-102/34	Acero/acier/aço	66	66	3,5	10
84-102/36	Zincado/zingée/zincado	66	66	3,5	10

## Bisagra reforzada 3 alas

*Charnière renforcée 3 ailes.*

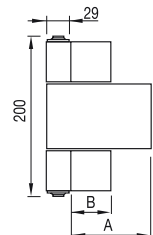
*Dobradiça reforçada 3 abas.*





Código code/código	Acabado	A (mm)	B (mm)	Espesor épaisseur/espessura (mm)	
84-103/10	Acero/acier/aço	115	70	6	8
84-103/12	Zincado/zingée/zincado	115	70	6	8

### Bisagra de librillo. Acero

Charnière livre 2 ailes. Acier

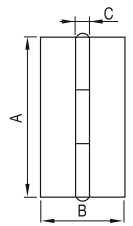
Dobradiça livre 2 corpos. Aço





Código code/código	A (mm)	B (mm)	øC (mm)	
84-115/08	80	51	16,0	45
84-115/10	100	57	18,0	25
84-115/15	150	57	18,5	25

### Cojinetes para pernios. Zincados

Roulement pour paumelles. Zingué

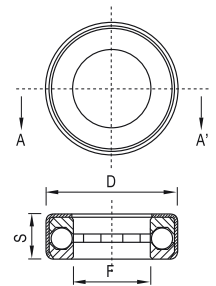
Rolamentos para pernos. Zincados





Código code/código	øF (mm)	øD (mm)	S (mm)	
86-032	10	17,5	6,0	100
86-036	12	20,0	6,5	100
86-038	14	22,0	6,7	100
86-040	20	29,0	6,5	50

### Pernio de 2 cuerpos. Acero

Paumelles deux corps. Acier

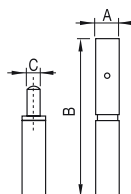
Perno 2 corpos. Aço



Código code/código	øA (mm)	B (mm)	øC (mm)	
86-050	8	50	5	36
86-054	10	60	6	36
86-058	10	70	6	36
86-062	12	60	8	24
86-066	12	70	8	35
86-070	14	80	8	24
86-100	16	90	10	20
86-104	16	100	10	20
86-108	18	110	12	20
86-112	20	120	12	16
86-114	22	130	14	20
86-116	25	140	16	12
86-120	30	150	18	12